



**MACHINE FOR FORMING AND GLUING
CARDBOARD TRAYS**

MCT-1/V



MCT-1/V



BLANKS MAGAZINE

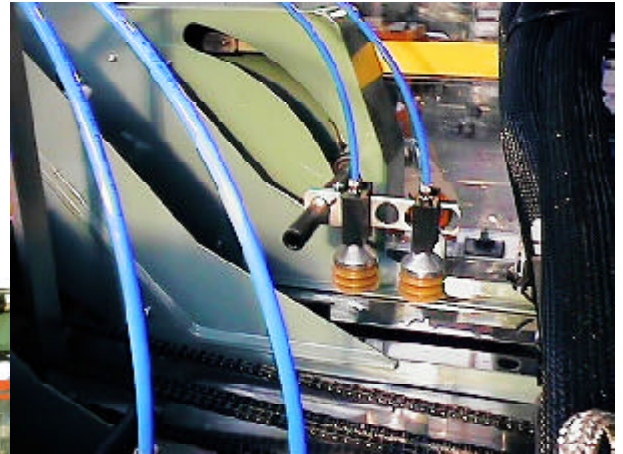

BLANKS FEEDER



MOULD AREA

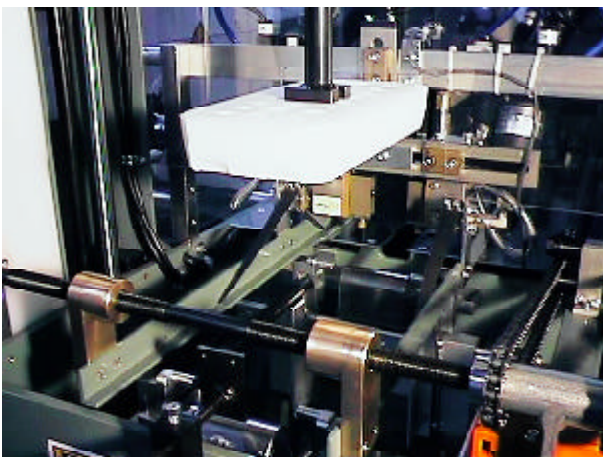

CONTROL PANEL
GLUE PROGRAMMER
80 boxes in memory

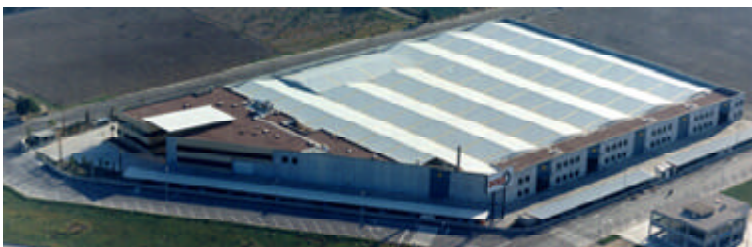

Handelsonderneming Versleijen BV

Kerkvaart 1
3641 EN Mijdrecht
Holland
Tel. +31 297-288506
Fax. +31 297-288497
E-mail: info@versleijen.nl
Web: www.versleijen.nl

MCT-1/V

AUTOMATIC AND ADJUSTABLE MACHINE OF TWO FORMING HEADS FOR ERECTING PUNNETS AND SMALL TRAYS TYPE C-1.

TECHNICAL SPECIFICATIONS	MCT-1/V
OPERATION	Mechanic, pneumatic and electric
GLUE SYSTEM	By injection, hot melt. Nordson (cap. 5 kg.)
PRODUCTION	2.500 to 3.000 pieces / hour, each head
TOTAL POWER	7 Kw.
ELECTRICAL SUPPLY <small>STANDARD</small>	380 v. (3P + N + E) - 50 Hz
NET WEIGHT - kg.	900
BLANK FEEDING SYSTEM	By vaccum
SIZE CHANGE	15 min.
AIR CONSUMPTION - l/min.	350 l/min.
WORKING AIR PRESSURE	6 bar

ADDITIONAL INFORMATION :

- Machine totally mechanical, driven by one motor thus ensuring a perfect synchronization of the two forming heads.
- Equipped with a timer for activating the hot melt equipment.
- Possibility to erect different sizes of box on each head.
- Mechanical speed control.
- Square sided or conical boxes can be formed.

MACHINE DIMENSIONS (mm):

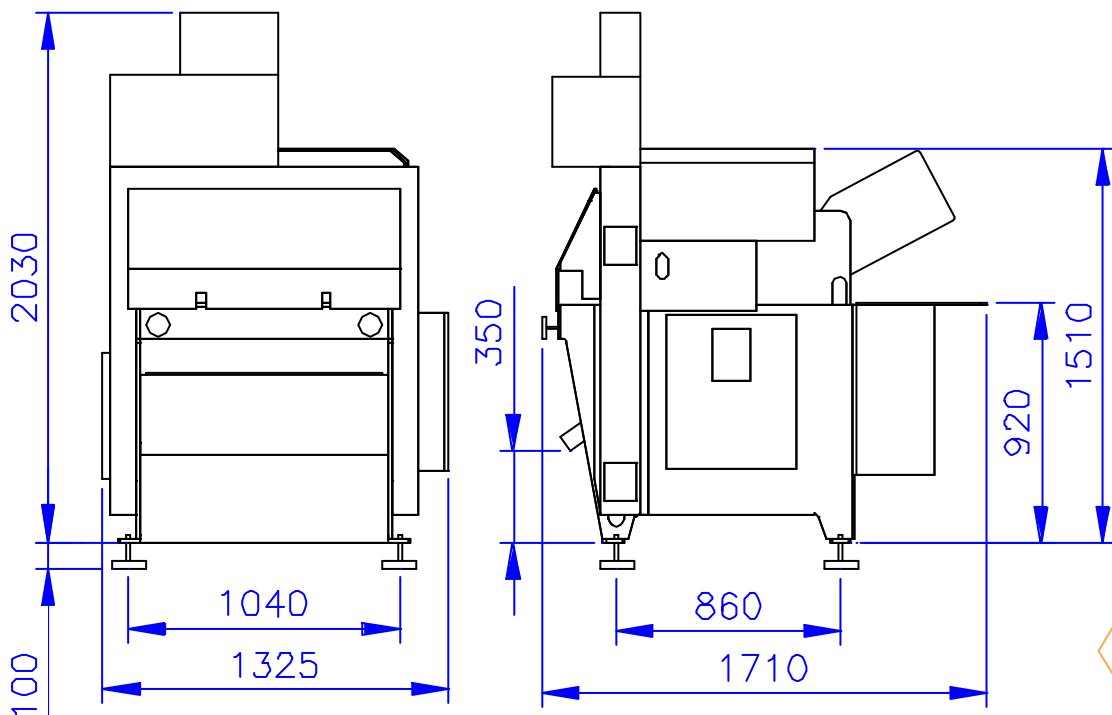

TECHNICAL SPECIFICATIONS (1-2)



BOX EXAMPLES

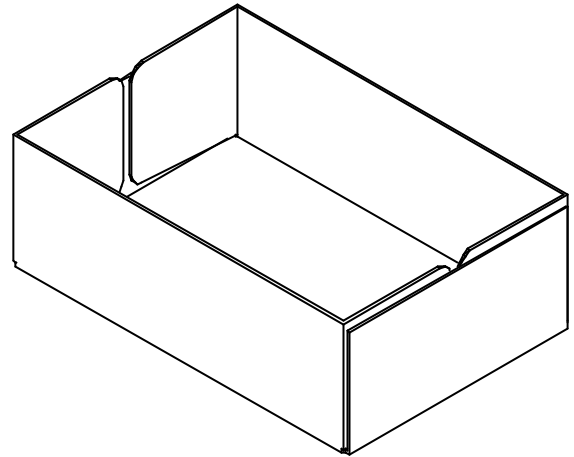
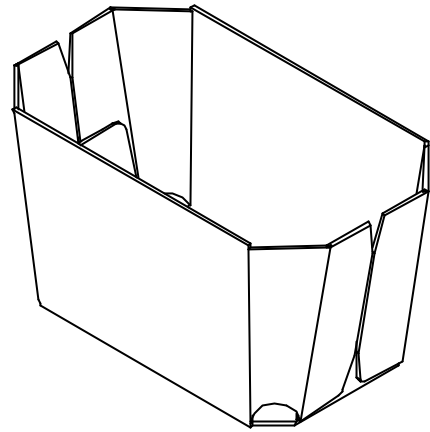
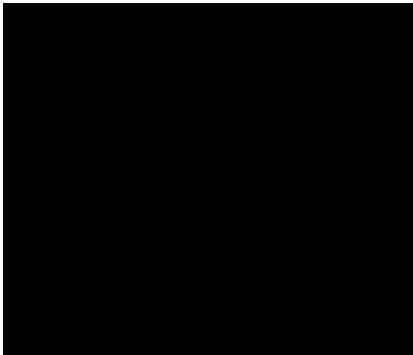
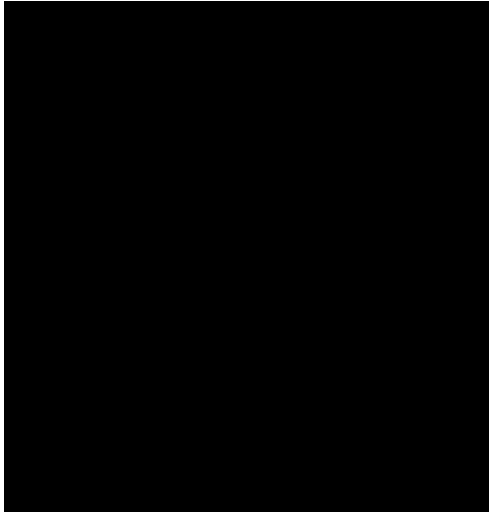

MAXIMUM AND MINIMUM SIZES (mm)

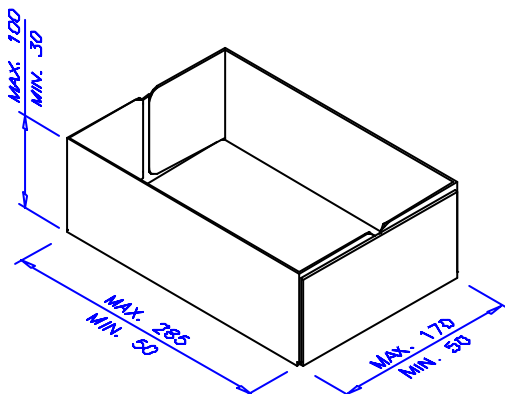
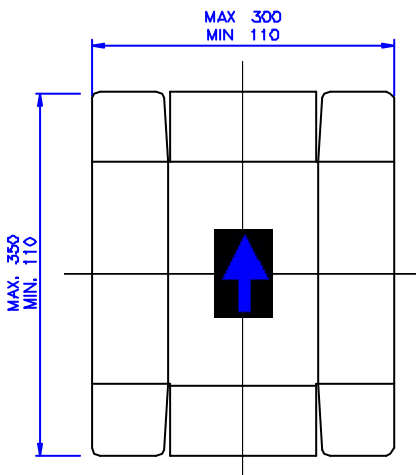

MEASUREMENTS NOT RELATED

FORMING SEQUENCE

